

HGC Hand grip clamps

Working load limit (WLL) 250 kg

The HGC hand grip clamps are suited for the individual transportation of light and thin materials. They have a jaw capacity of up to 10mm, and can lift up to 250kgs.

To operate the clamp you simply press down on the hand grip which compresses a spring. This allows the clamp jaw to open and you simply slide the clamp on to the material to be lifted.

Product group: I2



INFO

Available with 300 mm extended handle.

The HGC can also be supplied with an eyebolt instead of the handle.



Attaching

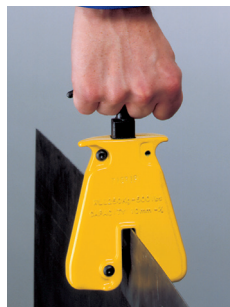

Transport

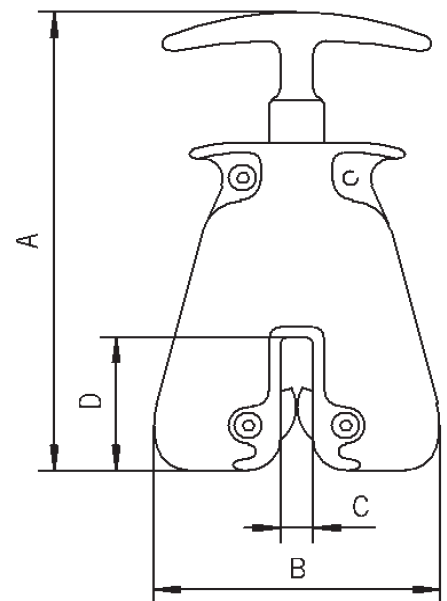

Technical data HGC

Model	Type/option	Art.-No.	*WLL kg	Jaw capacity mm	*Weight kg
HGC250	Standard	N51502415	250	0 - 10	1.4
HGC250 EX ¹	Extended handle	N4300013269	250	0 - 10	1.5
HGC250 EB ²	Eye bolt	N4300007661	250	0 - 10	1.4

Please contact our sales team for full technical drawings.

¹ EX = Extended handle (300 mm) ² EB = Eye bolt (instead of handle)

*Per clamp