

## TSZ Two way screw clamps

Working load limit (WLL) 500 - 7500 kg

The TSZ 'two way' screw clamps offers many possible uses. Ideally suited for the construction industry. The unique design of the spindle makes it easy to attach to 'angle' plate. This is achieved by simply turning the handle which applies the pressure to the plate holding it securely. Two lifting points enable it to be pulled in two different directions.

Product group: I2

## INFO

The surface of the material to be lifted must not exceed a hardness level of HRC 50/Brinell 480.

Shackles are not supplied.

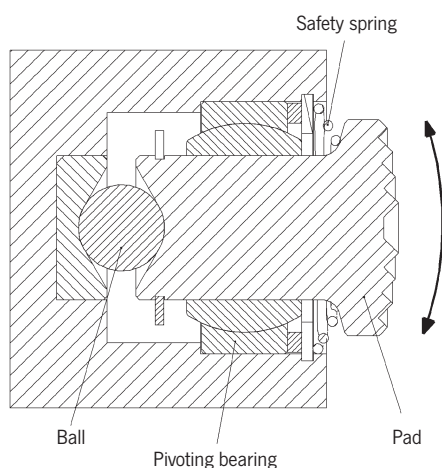
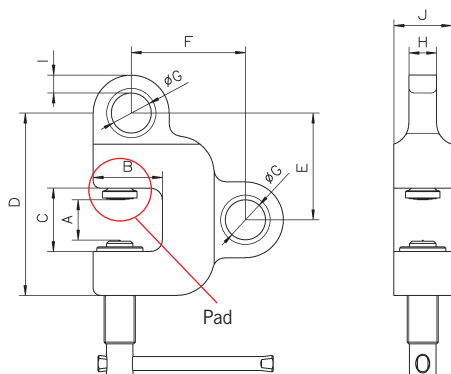

Functional drawing pivoting pad

## Technical data TSZ

Model	Art.-No.	*WLL kg	Jaw capacity mm	*Weight kg
TSZ500	N51502410	500	0 - 28	2.3
TSZ1500	N51502411	1500	0 - 35	5.6
TSZ3000	N51502412	3000	0 - 35	8.8
TSZ5000	N51502413	5000	0 - 40	16.2
TSZ7500	N51502414	7500	0 - 40	20.9

\*Per clamp

## Dimensions TSZ

Model	TSZ500	TSZ1500	TSZ3000	TSZ5000	TSZ7500
A, mm	28	35	35	40	40
B, mm	43	60	67	85	92
C, mm	45	55	65	75	75
D, mm	125	158	195	230	240
E, mm	72	93	114	133	143
F, mm	83	99	120	150	162
Ø G, mm	26	35	46	55	65
H, mm	16	24	34	40	50
I, mm	12	16	17	18	23
J, mm	35	50	60	75	80